

Wendell Wetland Services

105 Montague Road
Wendell, MA 01379
(978) 544-5607
ward.ves@gmail.com

November 7, 2023

Shutesbury Conservation Commission
P.O. Box 274
Shutesbury, MA 01330-0560

RE: DEP file # 286-302. Proposed Stairway and Seasonal Dock, 56 Lake Drive

Dear Commission Members:

On behalf of Leonard and Loretta Moskal, enclosed please find an Amended *Notice of Intent* for the above referenced project.

Wetland Delineation

The wetlands on the property were delineated by Ward W. Smith, SPWS on July 7, 2023. Flags A-1 to A-5 mark the top of the “bank” resource area, which was determined to be the first observable break in the slope. The area upgradient of the bank is lawn, and was evaluated using the methodology outlined in the Regulations at 310 CMR 10.55 and in the DEP handbook *Delineating Bordering Vegetated Wetlands under the Massachusetts Wetlands Protection Act* (1995). This area does not contain hydric soils, as determined by using the interagency document *Field Indicators for Identifying Hydric Soils in New England, Version 4* (2019), nor does it contain wetland hydrology. Therefore, this area is not a “bordering vegetated wetland.” However, the area immediately upgradient of the bank is within the “bordering land subject to flooding” resource area as per FEMA Floodplain Maps. The wetland flags were surveyed by Green River survey, and are shown on the Site Plan.

Proposed Work

This *Notice of Intent* has been amended to include an “after the fact” filing for a seasonal dock in Lake Wyola. The dock is four feet in width, and extends 24 feet into the Lake. The dock consists of an aluminum frame that is placed and removed annually in three four by ten- foot sections.

The original filing is for the extension of an existing staircase within the lawn on the property. The staircase will be constructed of railroad ties and gravel. The proposed work is within the 100-foot “buffer zone” to the “bank” resource area along Lake Wyola (this is called the Adjacent Upland Resource Area under the Bylaw). A total of 280 square feet of lawn is proposed to be converted to stairs.

Prior to construction, a double erosion control barrier consisting of a silt fence and straw waddle will be installed upgradient of the bank and bordering land subject to flooding resource areas in order to protect them during construction.

Any disturbed areas adjacent to the new stairway will be loamed and sown with grass seed, and will be returned to lawn. Sediment and erosion control will remain in place until the work area is stable and adjacent areas are re-vegetated, or until the Commission has granted permission for its removal.

Alternatives

The project is necessary for safety reasons, as the property owners would like to be able to access the Lake without the danger of slipping on the existing grassy slope. Other than the “no work” alternative, which does not fulfill the project purpose, all other alternatives would involve installing more impervious material within the buffer zone. The proposed alternative is the most cost-effective, low-impact option.

We respectfully request that the Commission issue an Order of Conditions for the work, along with any special conditions that the Commission finds necessary in order protect the Interests Identified in The Act and the Shutesbury General Wetlands Protection Bylaw.

Sincerely,
Wendell Wetland Services

Ward W. Smith, SPWS
Senior Professional Wetland Scientist

cc: Natural Heritage (certified mail)
Mark Stinson (electronic mail)



Massachusetts Department of Environmental Protection
Bureau of Resource Protection - Wetlands

WPA Form 3 – Notice of Intent

Massachusetts Wetlands Protection Act M.G.L. c. 131, §40

Provided by MassDEP:

MassDEP File Number

Document Transaction Number

Shutesbury

City/Town

Important:

When filling out forms on the computer, use only the tab key to move your cursor - do not use the return key.



Note:
Before completing this form consult your local Conservation Commission regarding any municipal bylaw or ordinance.

A. General Information

1. Project Location (**Note:** electronic filers will click on button to locate project site):

| | | |
|------------------------------|-----------------------|-----------------|
| <u>56 Lake Drive</u> | <u>Shutesbury</u> | <u>01072</u> |
| a. Street Address | b. City/Town | c. Zip Code |
| Latitude and Longitude: | | |
| <u>B</u> | <u>42.49913</u> | <u>72.43275</u> |
| f. Assessors Map/Plat Number | d. Latitude | e. Longitude |
| | <u>42</u> | |
| | g. Parcel /Lot Number | |

2. Applicant:

| | | |
|----------------------------|-------------------------------|------------------|
| <u>Leonard and Loretta</u> | <u>Moskal</u> | |
| a. First Name | b. Last Name | |
| c. Organization | | |
| <u>68 Ogden Street</u> | | |
| d. Street Address | | |
| <u>Holyoke</u> | <u>MA</u> | <u>01040</u> |
| e. City/Town | f. State | g. Zip Code |
| <u>(413) 313-1577</u> | <u>lennylorie@comcast.net</u> | |
| h. Phone Number | i. Fax Number | j. Email Address |

3. Property owner (required if different from applicant): Check if more than one owner

| | | |
|--------------------------|---------------|------------------|
| <u>Timothy and Kevin</u> | <u>Moskal</u> | |
| a. First Name | b. Last Name | |
| c. Organization | | |
| <u>56 Lake Drive</u> | | |
| d. Street Address | | |
| <u>Shutesbury</u> | <u>MA</u> | <u>01072</u> |
| e. City/Town | f. State | g. Zip Code |
| | | |
| h. Phone Number | i. Fax Number | j. Email address |

4. Representative (if any):

| | | |
|---------------------------------|---------------------------|------------------|
| <u>Ward</u> | <u>Smith</u> | |
| a. First Name | b. Last Name | |
| <u>Wendell Wetland Services</u> | | |
| c. Company | | |
| <u>105 Montague Road</u> | | |
| d. Street Address | | |
| <u>Wendell</u> | <u>MA</u> | <u>01379</u> |
| e. City/Town | f. State | g. Zip Code |
| <u>(978) 544-5607</u> | <u>ward.ves@gmail.com</u> | |
| h. Phone Number | i. Fax Number | j. Email address |

5. Total WPA Fee Paid (from NOI Wetland Fee Transmittal Form):

| | | |
|-------------------|-------------------|-----------------------|
| <u>\$ 110.00</u> | <u>\$ 42.50</u> | <u>\$ 67.50</u> |
| a. Total Fee Paid | b. State Fee Paid | c. City/Town Fee Paid |



Massachusetts Department of Environmental Protection
Bureau of Resource Protection - Wetlands

WPA Form 3 – Notice of Intent

Massachusetts Wetlands Protection Act M.G.L. c. 131, §40

Provided by MassDEP:

MassDEP File Number

Document Transaction Number

Shutesbury
City/Town

A. General Information (continued)

6. General Project Description:

It is proposed to install an extension of the existing staircase within the lawn. The stairway will be constructed of railroad ties and gravel. Prior to construction, sediment and erosion control will be installed between the work and the bank of Lake Wyola. All disturbed areas outside of the staircase will be re-vegetated with grass. The Notice is being amended to include a seasonal dock.

7a. Project Type Checklist: (Limited Project Types see Section A. 7b.)

- 1. Single Family Home
- 2. Residential Subdivision
- 3. Commercial/Industrial
- 4. Dock/Pier
- 5. Utilities
- 6. Coastal engineering Structure
- 7. Agriculture (e.g., cranberries, forestry)
- 8. Transportation
- 9. Other

7b. Is any portion of the proposed activity eligible to be treated as a limited project (including Ecological Restoration Limited Project) subject to 310 CMR 10.24 (coastal) or 310 CMR 10.53 (inland)?

- 1. Yes No If yes, describe which limited project applies to this project. (See 310 CMR 10.24 and 10.53 for a complete list and description of limited project types)

2. Limited Project Type

If the proposed activity is eligible to be treated as an Ecological Restoration Limited Project (310 CMR10.24(8), 310 CMR 10.53(4)), complete and attach Appendix A: Ecological Restoration Limited Project Checklist and Signed Certification.

8. Property recorded at the Registry of Deeds for:

Franklin

a. County

7478

c. Book

b. Certificate # (if registered land)

100

d. Page Number

B. Buffer Zone & Resource Area Impacts (temporary & permanent)

- 1. Buffer Zone Only – Check if the project is located only in the Buffer Zone of a Bordering Vegetated Wetland, Inland Bank, or Coastal Resource Area.
- 2. Inland Resource Areas (see 310 CMR 10.54-10.58; if not applicable, go to Section B.3, Coastal Resource Areas).

Check all that apply below. Attach narrative and any supporting documentation describing how the project will meet all performance standards for each of the resource areas altered, including standards requiring consideration of alternative project design or location.



Massachusetts Department of Environmental Protection
 Bureau of Resource Protection - Wetlands

WPA Form 3 – Notice of Intent

Massachusetts Wetlands Protection Act M.G.L. c. 131, §40

Provided by MassDEP:

MassDEP File Number

Document Transaction Number

Shutesbury

City/Town

B. Buffer Zone & Resource Area Impacts (temporary & permanent) (cont'd)

For all projects affecting other Resource Areas, please attach a narrative explaining how the resource area was delineated.

| Resource Area | Size of Proposed Alteration | Proposed Replacement (if any) |
|-----------------------------------------------------------------------------|------------------------------------------------------|-------------------------------|
| a. <input checked="" type="checkbox"/> Bank | 4 1. linear feet | 2. linear feet |
| b. <input type="checkbox"/> Bordering Vegetated Wetland | 1. square feet | 2. square feet |
| c. <input checked="" type="checkbox"/> Land Under Waterbodies and Waterways | < 1 1. square feet 0 3. cubic yards dredged | 2. square feet |

| Resource Area | Size of Proposed Alteration | Proposed Replacement (if any) |
|----------------------------------------------------------------|-----------------------------------------------------------------------|-------------------------------|
| d. <input type="checkbox"/> Bordering Land Subject to Flooding | 1. square feet | 2. square feet |
| | 3. cubic feet of flood storage lost | 4. cubic feet replaced |
| e. <input type="checkbox"/> Isolated Land Subject to Flooding | 1. square feet | |
| | 2. cubic feet of flood storage lost | 3. cubic feet replaced |
| f. <input type="checkbox"/> Riverfront Area | 1. Name of Waterway (if available) - specify coastal or inland | |

2. Width of Riverfront Area (check one):

- 25 ft. - Designated Densely Developed Areas only
- 100 ft. - New agricultural projects only
- 200 ft. - All other projects

3. Total area of Riverfront Area on the site of the proposed project: _____ square feet

4. Proposed alteration of the Riverfront Area:

a. total square feet _____ b. square feet within 100 ft. _____ c. square feet between 100 ft. and 200 ft. _____

5. Has an alternatives analysis been done and is it attached to this NOI? Yes No

6. Was the lot where the activity is proposed created prior to August 1, 1996? Yes No

3. Coastal Resource Areas: (See 310 CMR 10.25-10.35)

Note: for coastal riverfront areas, please complete **Section B.2.f.** above.



Massachusetts Department of Environmental Protection
Bureau of Resource Protection - Wetlands

WPA Form 3 - Notice of Intent

Massachusetts Wetlands Protection Act M.G.L. c. 131, §40

Provided by MassDEP:

MassDEP File Number

Document Transaction Number

Shutesbury

City/Town

B. Buffer Zone & Resource Area Impacts (temporary & permanent) (cont'd)

Check all that apply below. Attach narrative and supporting documentation describing how the project will meet all performance standards for each of the resource areas altered, including standards requiring consideration of alternative project design or location.

Online Users: Include your document transaction number (provided on your receipt page) with all supplementary information you submit to the Department.

Table with 3 columns: Resource Area, Size of Proposed Alteration, Proposed Replacement (if any). Rows include Designated Port Areas, Land Under the Ocean, Barrier Beach, Coastal Beaches, Coastal Dunes.

Table with 3 columns: Resource Area, Size of Proposed Alteration, Proposed Replacement (if any). Rows include Coastal Banks, Rocky Intertidal Shores, Salt Marshes, Land Under Salt Ponds, Land Containing Shellfish, Fish Runs, Land Subject to Coastal Storm Flowage.

4. Restoration/Enhancement
If the project is for the purpose of restoring or enhancing a wetland resource area in addition to the square footage that has been entered in Section B.2.b or B.3.h above, please enter the additional amount here.

a. square feet of BVW b. square feet of Salt Marsh

5. Project Involves Stream Crossings

a. number of new stream crossings b. number of replacement stream crossings



Massachusetts Department of Environmental Protection
Bureau of Resource Protection - Wetlands

WPA Form 3 – Notice of Intent

Massachusetts Wetlands Protection Act M.G.L. c. 131, §40

Provided by MassDEP:

MassDEP File Number

Document Transaction Number

Shutesbury
City/Town

C. Other Applicable Standards and Requirements

- This is a proposal for an Ecological Restoration Limited Project. Skip Section C and complete Appendix A: Ecological Restoration Limited Project Checklists – Required Actions (310 CMR 10.11).

Streamlined Massachusetts Endangered Species Act/Wetlands Protection Act Review

- Is any portion of the proposed project located in **Estimated Habitat of Rare Wildlife** as indicated on the most recent Estimated Habitat Map of State-Listed Rare Wetland Wildlife published by the Natural Heritage and Endangered Species Program (NHESP)? To view habitat maps, see the *Massachusetts Natural Heritage Atlas* or go to http://maps.massgis.state.ma.us/PRI_EST_HAB/viewer.htm.

- a. Yes No

If yes, include proof of mailing or hand delivery of NOI to:

**Natural Heritage and Endangered Species Program
Division of Fisheries and Wildlife
1 Rabbit Hill Road
Westborough, MA 01581**

- online mapping
b. Date of map

If yes, the project is also subject to Massachusetts Endangered Species Act (MESA) review (321 CMR 10.18). To qualify for a streamlined, 30-day, MESA/Wetlands Protection Act review, please complete Section C.1.c, and include requested materials with this Notice of Intent (NOI); *OR* complete Section C.2.f, if applicable. *If MESA supplemental information is not included with the NOI, by completing Section 1 of this form, the NHESP will require a separate MESA filing which may take up to 90 days to review (unless noted exceptions in Section 2 apply, see below).*

- c. Submit Supplemental Information for Endangered Species Review*

- Percentage/acreage of property to be altered:

| | |
|----------------------------------|---------------------------------------------------------------------------|
| (a) within wetland Resource Area | <u>120 s.f. (aerial coverage of dock, not fill)</u> percentage/acreage |
| (b) outside Resource Area | <u>240 s.f. (staircases)</u> percentage/acreage |

- Assessor's Map or right-of-way plan of site

- Project plans for entire project site, including wetland resource areas and areas outside of wetlands jurisdiction, showing existing and proposed conditions, existing and proposed tree/vegetation clearing line, and clearly demarcated limits of work **

- Project description (including description of impacts outside of wetland resource area & buffer zone)
- Photographs representative of the site

* Some projects **not** in Estimated Habitat may be located in Priority Habitat, and require NHESP review (see <https://www.mass.gov/endangered-species-act-mesa-regulatory-review>).

Priority Habitat includes habitat for state-listed plants and strictly upland species not protected by the Wetlands Protection Act.

** MESA projects may not be segmented (321 CMR 10.16). The applicant must disclose full development plans even if such plans are not required as part of the Notice of Intent process.



Massachusetts Department of Environmental Protection
 Bureau of Resource Protection - Wetlands
WPA Form 3 – Notice of Intent
 Massachusetts Wetlands Protection Act M.G.L. c. 131, §40

| | |
|-----------------------------|--|
| Provided by MassDEP: | |
| MassDEP File Number | |
| Document Transaction Number | |
| Shutesbury | |
| City/Town | |

C. Other Applicable Standards and Requirements (cont'd)

(c) MESA filing fee (fee information available at <https://www.mass.gov/how-to/how-to-file-for-a-mesa-project-review>).
 Make check payable to "Commonwealth of Massachusetts - NHESP" and **mail to NHESP** at above address

Projects altering 10 or more acres of land, also submit:

- (d) Vegetation cover type map of site
- (e) Project plans showing Priority & Estimated Habitat boundaries
- (f) OR Check One of the Following

- 1. Project is exempt from MESA review.
 Attach applicant letter indicating which MESA exemption applies. (See 321 CMR 10.14, <https://www.mass.gov/service-details/exemptions-from-review-for-projectsactivities-in-priority-habitat>; the NOI must still be sent to NHESP if the project is within estimated habitat pursuant to 310 CMR 10.37 and 10.59.)
- 2. Separate MESA review ongoing. a. NHESP Tracking # _____ b. Date submitted to NHESP _____
- 3. Separate MESA review completed.
 Include copy of NHESP "no Take" determination or valid Conservation & Management Permit with approved plan.

3. For coastal projects only, is any portion of the proposed project located below the mean high water line or in a fish run?
 a. Not applicable – project is in inland resource area only b. Yes No

If yes, include proof of mailing, hand delivery, or electronic delivery of NOI to either:

South Shore - Cohasset to Rhode Island border, and the Cape & Islands:

North Shore - Hull to New Hampshire border:

Division of Marine Fisheries -
 Southeast Marine Fisheries Station
 Attn: Environmental Reviewer
 836 South Rodney French Blvd.
 New Bedford, MA 02744
 Email: dmf.envreview-south@mass.gov

Division of Marine Fisheries -
 North Shore Office
 Attn: Environmental Reviewer
 30 Emerson Avenue
 Gloucester, MA 01930
 Email: dmf.envreview-north@mass.gov

Also if yes, the project may require a Chapter 91 license. For coastal towns in the Northeast Region, please contact MassDEP's Boston Office. For coastal towns in the Southeast Region, please contact MassDEP's Southeast Regional Office.

c. Is this an aquaculture project? d. Yes No

If yes, include a copy of the Division of Marine Fisheries Certification Letter (M.G.L. c. 130, § 57).



Massachusetts Department of Environmental Protection
Bureau of Resource Protection - Wetlands

WPA Form 3 – Notice of Intent

Massachusetts Wetlands Protection Act M.G.L. c. 131, §40

Provided by MassDEP:

MassDEP File Number

Document Transaction Number

Shutesbury
City/Town

Online Users:
Include your document transaction number (provided on your receipt page) with all supplementary information you submit to the Department.

C. Other Applicable Standards and Requirements (cont'd)

- 4. Is any portion of the proposed project within an Area of Critical Environmental Concern (ACEC)?
 a. Yes No If yes, provide name of ACEC (see instructions to WPA Form 3 or MassDEP Website for ACEC locations). **Note:** electronic filers click on Website.
 b. ACEC

- 5. Is any portion of the proposed project within an area designated as an Outstanding Resource Water (ORW) as designated in the Massachusetts Surface Water Quality Standards, 314 CMR 4.00?
 a. Yes No
- 6. Is any portion of the site subject to a Wetlands Restriction Order under the Inland Wetlands Restriction Act (M.G.L. c. 131, § 40A) or the Coastal Wetlands Restriction Act (M.G.L. c. 130, § 105)?
 a. Yes No
- 7. Is this project subject to provisions of the MassDEP Stormwater Management Standards?
 a. Yes. Attach a copy of the Stormwater Report as required by the Stormwater Management Standards per 310 CMR 10.05(6)(k)-(q) and check if:
 - 1. Applying for Low Impact Development (LID) site design credits (as described in Stormwater Management Handbook Vol. 2, Chapter 3)
 - 2. A portion of the site constitutes redevelopment
 - 3. Proprietary BMPs are included in the Stormwater Management System.
 b. No. Check why the project is exempt:
 - 1. Single-family house
 - 2. Emergency road repair
 - 3. Small Residential Subdivision (less than or equal to 4 single-family houses or less than or equal to 4 units in multi-family housing project) with no discharge to Critical Areas.

D. Additional Information

- This is a proposal for an Ecological Restoration Limited Project. Skip Section D and complete Appendix A: Ecological Restoration Notice of Intent – Minimum Required Documents (310 CMR 10.12).

Applicants must include the following with this Notice of Intent (NOI). See instructions for details.

Online Users: Attach the document transaction number (provided on your receipt page) for any of the following information you submit to the Department.

- 1. USGS or other map of the area (along with a narrative description, if necessary) containing sufficient information for the Conservation Commission and the Department to locate the site. (Electronic filers may omit this item.)
- 2. Plans identifying the location of proposed activities (including activities proposed to serve as a Bordering Vegetated Wetland [BVW] replication area or other mitigating measure) relative to the boundaries of each affected resource area.



Massachusetts Department of Environmental Protection
Bureau of Resource Protection - Wetlands

WPA Form 3 – Notice of Intent

Massachusetts Wetlands Protection Act M.G.L. c. 131, §40

Provided by MassDEP:

MassDEP File Number

Document Transaction Number

Shutesbury
City/Town

D. Additional Information (cont'd)

3. Identify the method for BVW and other resource area boundary delineations (MassDEP BVW Field Data Form(s), Determination of Applicability, Order of Resource Area Delineation, etc.), and attach documentation of the methodology.

4. List the titles and dates for all plans and other materials submitted with this NOI.

Site Plan

a. Plan Title

Green River Survey

Daniel P. Salls, PLS

b. Prepared By

c. Signed and Stamped by

10/20/2023

d. Final Revision Date

e. Scale

f. Additional Plan or Document Title

g. Date

5. If there is more than one property owner, please attach a list of these property owners not listed on this form.

6. Attach proof of mailing for Natural Heritage and Endangered Species Program, if needed.

7. Attach proof of mailing for Massachusetts Division of Marine Fisheries, if needed.

8. Attach NOI Wetland Fee Transmittal Form

9. Attach Stormwater Report, if needed.

E. Fees

1. Fee Exempt: No filing fee shall be assessed for projects of any city, town, county, or district of the Commonwealth, federally recognized Indian tribe housing authority, municipal housing authority, or the Massachusetts Bay Transportation Authority.

Applicants must submit the following information (in addition to pages 1 and 2 of the NOI Wetland Fee Transmittal Form) to confirm fee payment:

1018

2. Municipal Check Number

9/14/2023

3. Check date

Paid Online

4. State Check Number

5. Check date

Ward

6. Payor name on check: First Name

Smith

7. Payor name on check: Last Name



Massachusetts Department of Environmental Protection
Bureau of Resource Protection - Wetlands

WPA Form 3 – Notice of Intent

Massachusetts Wetlands Protection Act M.G.L. c. 131, §40

Provided by MassDEP:

MassDEP File Number

Document Transaction Number

Shutesbury
City/Town

F. Signatures and Submittal Requirements

I hereby certify under the penalties of perjury that the foregoing Notice of Intent and accompanying plans, documents, and supporting data are true and complete to the best of my knowledge. I understand that the Conservation Commission will place notification of this Notice in a local newspaper at the expense of the applicant in accordance with the wetlands regulations, 310 CMR 10.05(5)(a).

I further certify under penalties of perjury that all abutters were notified of this application, pursuant to the requirements of M.G.L. c. 131, § 40. Notice must be made by Certificate of Mailing or in writing by hand delivery or certified mail (return receipt requested) to all abutters within 100 feet of the property line of the project location.

1. Signature of Applicant

2. Date

3. Signature of Property Owner (if different)

4. Date

5. Signature of Representative (if any)

6. Date

For Conservation Commission:

Two copies of the completed Notice of Intent (Form 3), including supporting plans and documents, two copies of the NOI Wetland Fee Transmittal Form, and the city/town fee payment, to the Conservation Commission by certified mail or hand delivery.

For MassDEP:

One copy of the completed Notice of Intent (Form 3), including supporting plans and documents, one copy of the NOI Wetland Fee Transmittal Form, and a **copy** of the state fee payment to the MassDEP Regional Office (see Instructions) by certified mail or hand delivery.

Other:

If the applicant has checked the "yes" box in any part of Section C, Item 3, above, refer to that section and the Instructions for additional submittal requirements.

The original and copies must be sent simultaneously. Failure by the applicant to send copies in a timely manner may result in dismissal of the Notice of Intent.



Massachusetts Department of Environmental Protection
 Bureau of Resource Protection - Wetlands
NOI Wetland Fee Transmittal Form
 Massachusetts Wetlands Protection Act M.G.L. c. 131, §40

Important: When filling out forms on the computer, use only the tab key to move your cursor - do not use the return key.

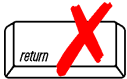

A. Applicant Information

1. Location of Project:

| | |
|----------------------|-------------------|
| <u>56 Lake Drive</u> | <u>Shutesbury</u> |
| a. Street Address | b. City/Town |
| <u>Paid Online</u> | |
| c. Check number | d. Fee amount |

2. Applicant Mailing Address:

| | | |
|----------------------------|-------------------------------|------------------|
| <u>Leonard and Loretta</u> | <u>Moskal</u> | |
| a. First Name | b. Last Name | |
| <u></u> | | |
| c. Organization | | |
| <u>68 Ogden Street</u> | | |
| d. Mailing Address | | |
| <u>Holyoke</u> | <u>MA</u> | <u>01040</u> |
| e. City/Town | f. State | g. Zip Code |
| <u>(413) 313-1577</u> | <u>lennylorie@comcast.net</u> | |
| h. Phone Number | i. Fax Number | j. Email Address |

3. Property Owner (if different):

| | | |
|--------------------|---------------|------------------|
| <u></u> | <u></u> | |
| a. First Name | b. Last Name | |
| <u></u> | | |
| c. Organization | | |
| <u></u> | | |
| d. Mailing Address | | |
| <u></u> | <u></u> | <u></u> |
| e. City/Town | f. State | g. Zip Code |
| <u></u> | <u></u> | <u></u> |
| h. Phone Number | i. Fax Number | j. Email Address |

B. Fees

Fee should be calculated using the following process & worksheet. **Please see Instructions before filling out worksheet.**

Step 1/Type of Activity: Describe each type of activity that will occur in wetland resource area and buffer zone.

Step 2/Number of Activities: Identify the number of each type of activity.

Step 3/Individual Activity Fee: Identify each activity fee from the six project categories listed in the instructions.

Step 4/Subtotal Activity Fee: Multiply the number of activities (identified in Step 2) times the fee per category (identified in Step 3) to reach a subtotal fee amount. Note: If any of these activities are in a Riverfront Area in addition to another Resource Area or the Buffer Zone, the fee per activity should be multiplied by 1.5 and then added to the subtotal amount.

Step 5/Total Project Fee: Determine the total project fee by adding the subtotal amounts from Step 4.

Step 6/Fee Payments: To calculate the state share of the fee, divide the total fee in half and subtract \$12.50. To calculate the city/town share of the fee, divide the total fee in half and add \$12.50.

To calculate filing fees, refer to the category fee list and examples in the instructions for filling out WPA Form 3 (Notice of Intent).



Massachusetts Department of Environmental Protection
 Bureau of Resource Protection - Wetlands
NOI Wetland Fee Transmittal Form
 Massachusetts Wetlands Protection Act M.G.L. c. 131, §40

B. Fees (continued)

| Step 1/Type of Activity | Step 2/Number of Activities | Step 3/Individual Activity Fee | Step 4/Subtotal Activity Fee |
|-----------------------------|----------------------------------|--------------------------------|-------------------------------|
| Work associated with sfh. | 1 | \$ 110.00 | |
| | | | |
| | | | |
| | | | |
| | | | |
| | | | |
| | | | |
| | | | |
| | | | |
| | Step 5/Total Project Fee: | | \$ 110.00 |
| | | | |
| Step 6/Fee Payments: | | | |
| | Total Project Fee: | | \$ 110.00 |
| | | | a. Total Fee from Step 5 |
| | State share of filing Fee: | | \$ 42.50 |
| | | | b. 1/2 Total Fee less \$12.50 |
| | City/Town share of filing Fee: | | \$ 67.50 |
| | | | c. 1/2 Total Fee plus \$12.50 |

C. Submittal Requirements

- a.) Complete pages 1 and 2 and send with a check or money order for the state share of the fee, payable to the Commonwealth of Massachusetts.

Department of Environmental Protection
 Box 4062
 Boston, MA 02211

- b.) **To the Conservation Commission:** Send the Notice of Intent or Abbreviated Notice of Intent; a **copy** of this form; and the city/town fee payment.

To MassDEP Regional Office (see Instructions): Send a copy of the Notice of Intent or Abbreviated Notice of Intent; a **copy** of this form; and a **copy** of the state fee payment. (E-filers of Notices of Intent may submit these electronically.)

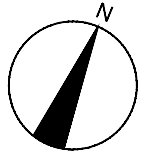

LEGEND:

- FOUND IRON PIPE
- ◆ WETLAND FLAG - TOP OF BANK
- △ UNMARKED POINT
- [Dotted pattern] TOP OF BANK 50' BUFFER ZONE
- [Horizontal lines] TOP OF BANK 100' BUFFER ZONE
- [Diagonal lines] 100-YEAR FLOODPLAIN

N/F
 Stephen R. Dalmus &
 Linda C. Bills
 Bk 5197 Pg 16
 Tax Map ZB Lot 41
 see PB 121 Pg 54

NOTE:
 Mean lake elevation (833'+/-) is from
 the 1990 USGS map "Orange,
 Massachusetts"
 map no. 42072-E3-TM-025
 (NGVD 1929)

Lake Drive

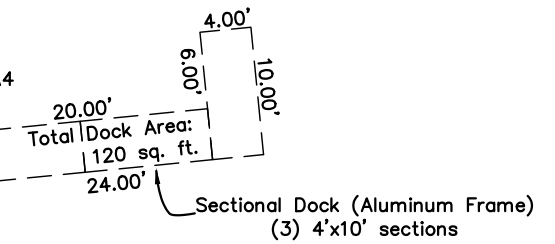
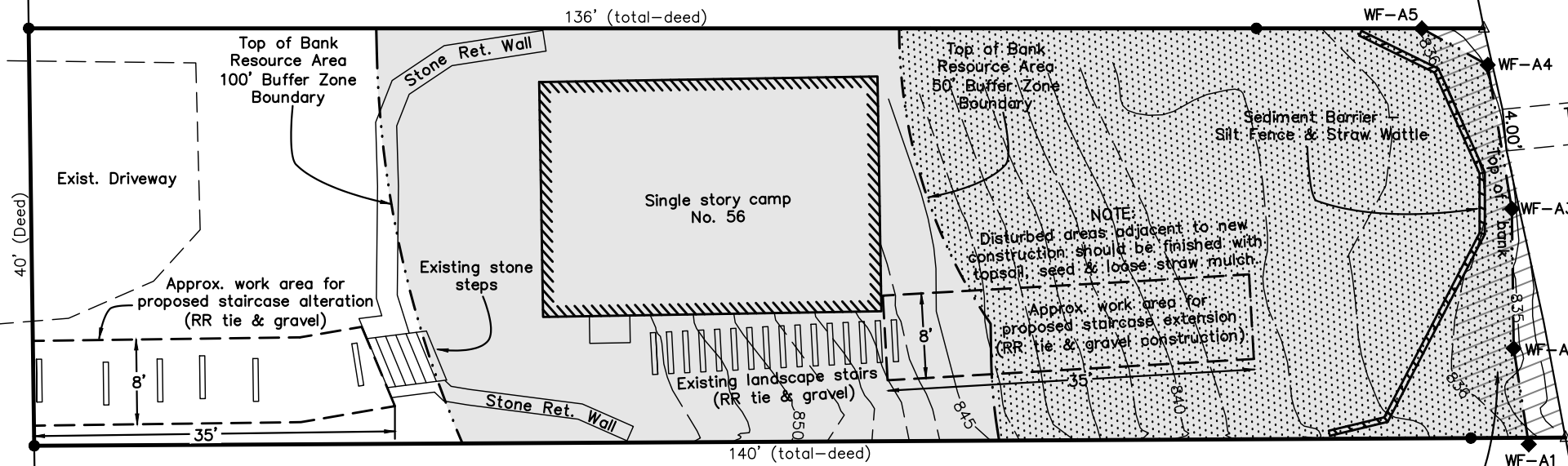

Lake Myola
 lake elev. 833'+/-

NOTE:
 Disturbed areas adjacent to new
 construction should be finished with
 topsoil, seed & loose straw mulch.
 Approx. work area for
 proposed staircase extension
 (RR tie & gravel construction)

100-Year Floodplain
 "Bordering Land Subject to
 Flooding Resource Area"
 from lake to the 836' contour line.
 (as shown on FEMA FIRM 2501280005A - NGVD 1929)

N/F
 Karen E. Burns, Trustee
 The 58 Lake Drive Realty
 Trust
 Bk 6451 Pg 34
 Tax Map ZB Lot 43

GRAPHIC SCALE:

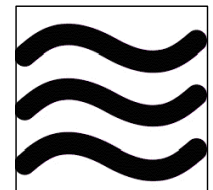

Green River Survey
 289 Main Street
 Greenfield, MA 01301
 eric@greenriversurvey.com
 (413)361-4882

To the best of my professional knowledge,
 information, and belief, I hereby report that the
 structures shown hereon
 are located as shown.

PROFESSIONAL LAND SURVEYOR 08-27-2023

LEGAL REFERENCE: Deed Bk. 7478 Pg 100
 Lot 42 Plan Bk 11 Pg 52

DRAWN BY: EWF CHK'D BY: DPS

SCALE: 1"=15' DATE: 08/27/2023

REVISION: 10/20/2023 Added dock
 Changed scale

SITE PLAN

Showing proposed proposed staircase
 extension & proposed staircase replacement.

PREPARED FOR: Leonard A. & Loretta J.
 Moskal

LOCATION: 56 Lake Drive Tax Map B
 Shutesbury, MA Lot 42